

## OTGMA2 ASSEMBLY INSTRUCTIONS

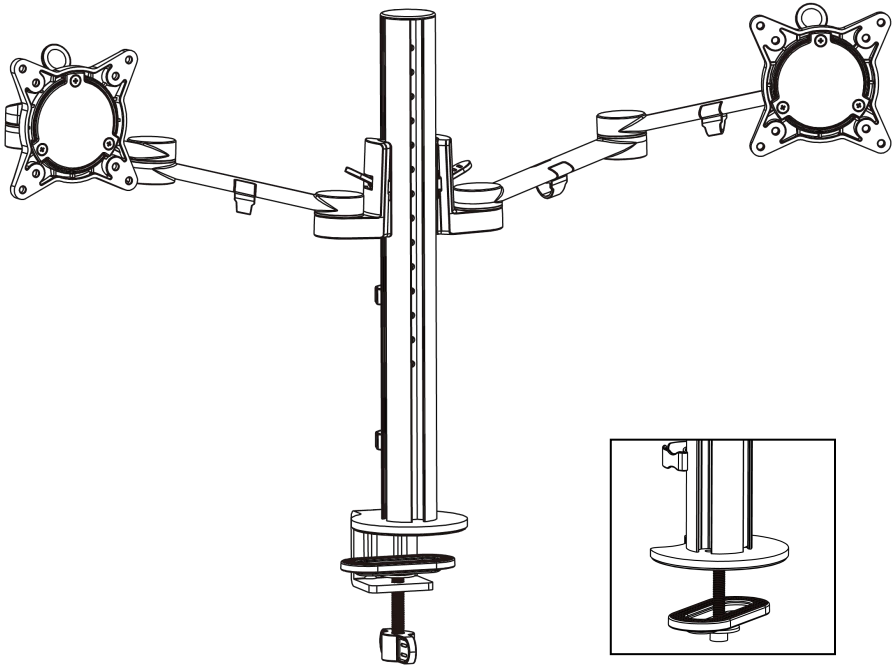

**LOADING CAPACITY** 2.2 - 17.6 lbs per monitor

**SCREEN SIZE** 17" - 29"



## Parts List

### Components

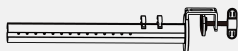

1. Base & Pole (X1)

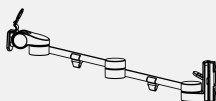

2. Arm (X2)

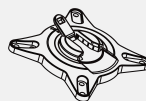

3. VESA Plate (X2)

### Parts in the Regular Screw Bag

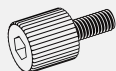

A. M4X9 Screw (X8)



B. M4X12 Screw (X8)

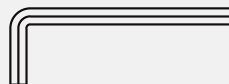

C. 4mm Allen Key (X1)



D. 5mm Allen Key (X1)

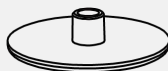

E. Top Cap (X1)

### Parts in the Grommet Installation Parts Bag (Used for grommet installation)



F. M6X12 Screw (X2)



G. Base Plate (X1)

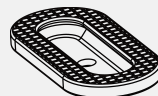

H. Fixing Plate (X1)



I. Spacer (X1)



J. Long Screw (X1)

EXPLODED VIEW

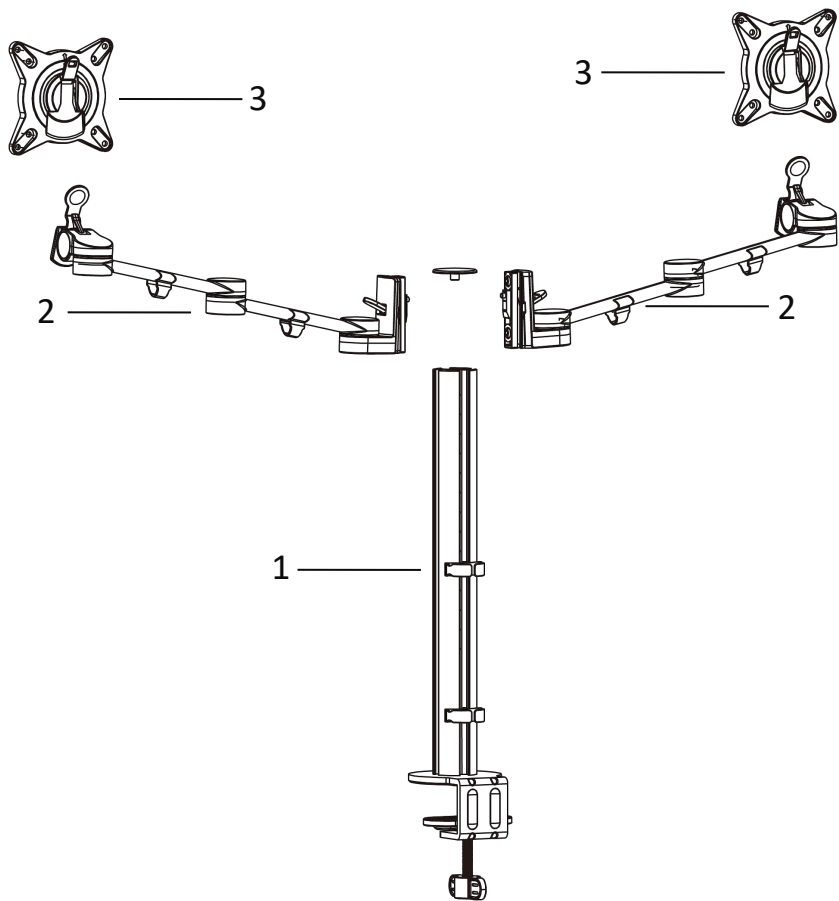

## STEP 1 - Select a Base Installation Option

### Option 1a - Clamp Method

**1a**



Thickness of worksurface:  
.5" – 1.25"

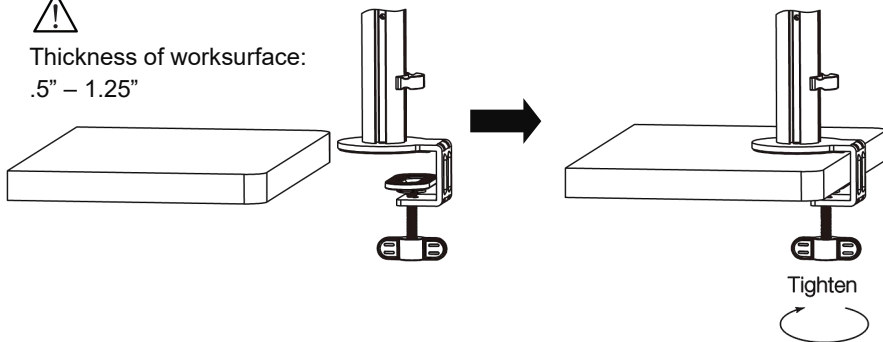

### Option 1b - Grommet Method

**1b-1**

Loosen the screws to remove the clamp base.

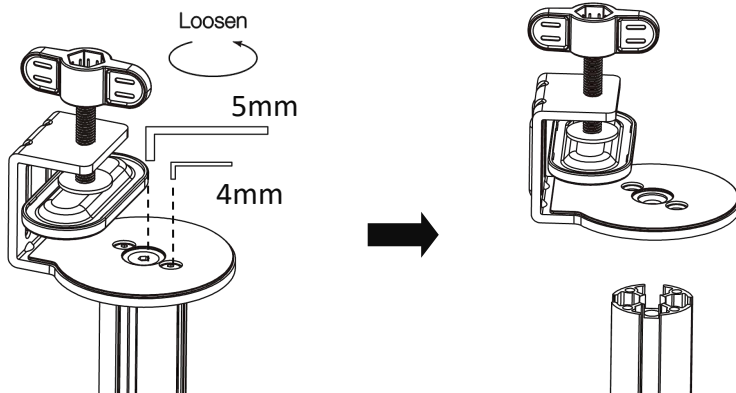

## 1b-2

Connect the grommet base plate to the pole.

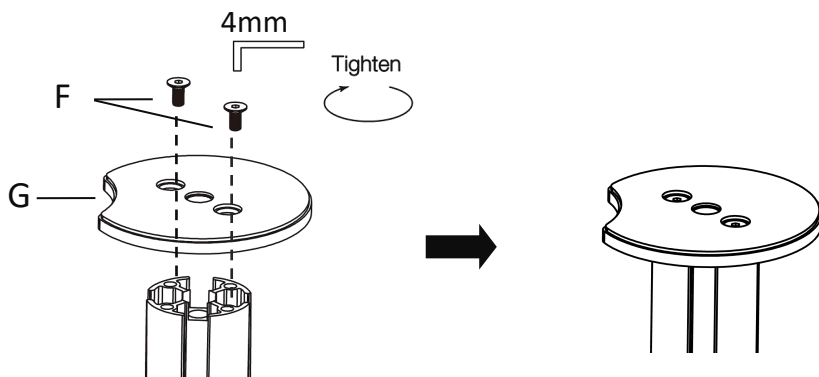

## 1b-3

Center and tighten the long screw through desk as below displays.

Fits all OTG grommets and  
round grommets up to 3.5"

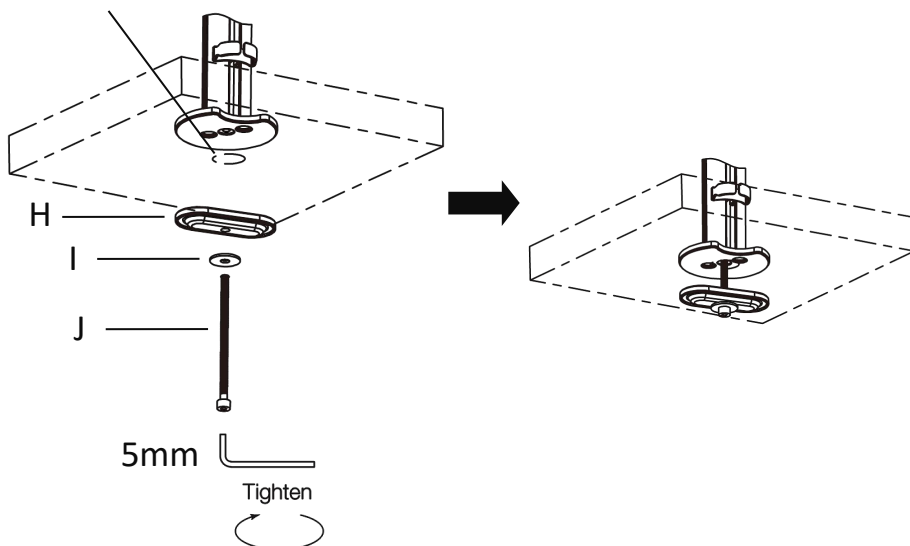

## STEP 2 - Arm Installation

### 2-1

Press and hold down the lever while sliding into the pole

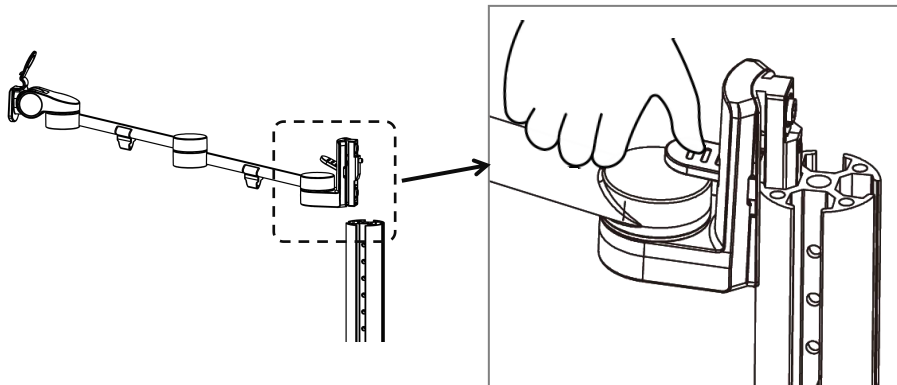

### 2-2

Release the lever when desired height is reached.

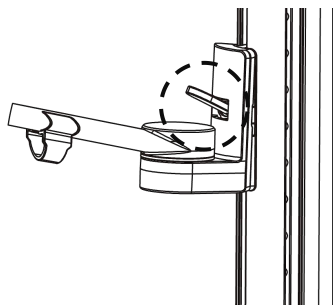

**NOTE:** Please ensure the arm is firmly locked into the hole on the pole.

### 2-3

Place top cap on the top of the pole and push down to secure.

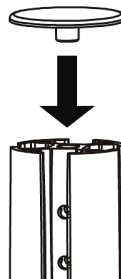

## STEP 3 - VESA Plate Installation

3

Tighten screws into VESA plate on VESA compliant monitor.

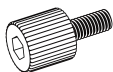
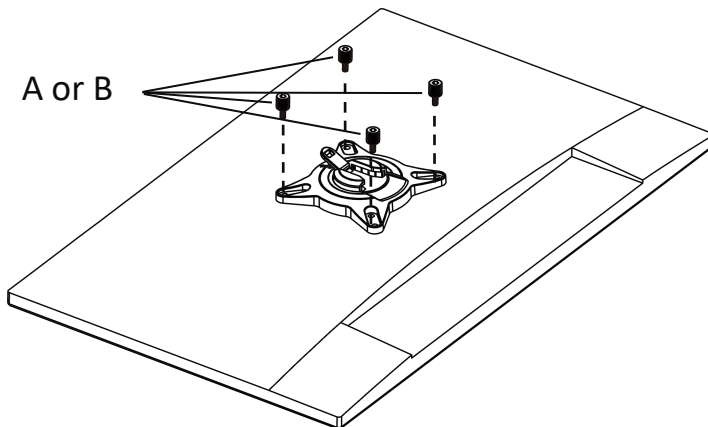

Part A is the default VESA screw size for most monitors and is designed to be hand-tightened.



Part B is provided to accommodate monitors requiring longer VESA screws.



## STEP 4 - Monitor Installation

4

Slide in and lock-in.

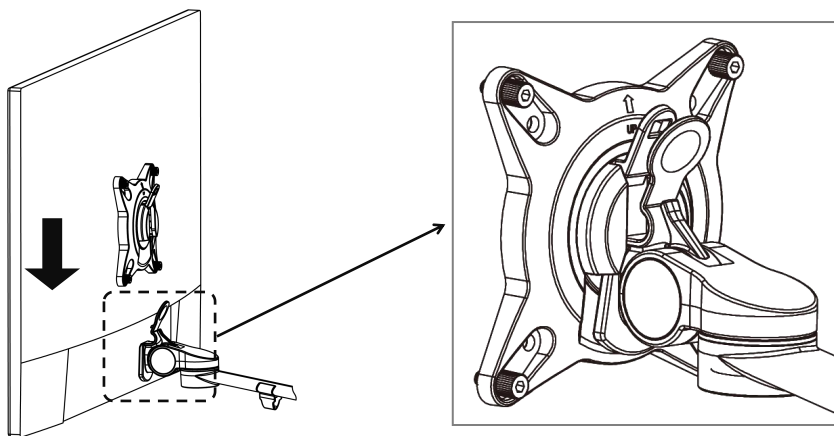

### NOTE

NOTE: Before removing the monitor, ensure the **UP** arrow towards upward.

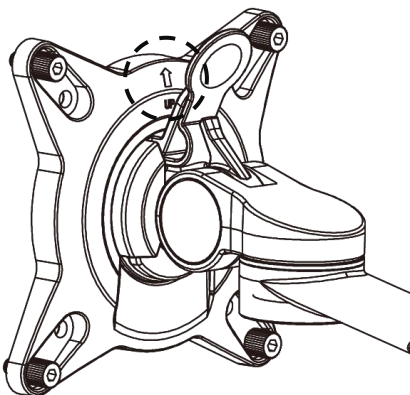

### NOTE

Press down lever on the VESA plate and carefully lift the monitor upwards.

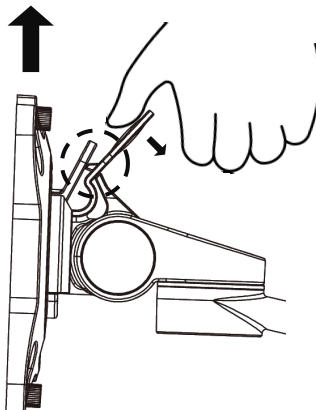

## NOTE

Tilt adjustment to hold heavier monitor.

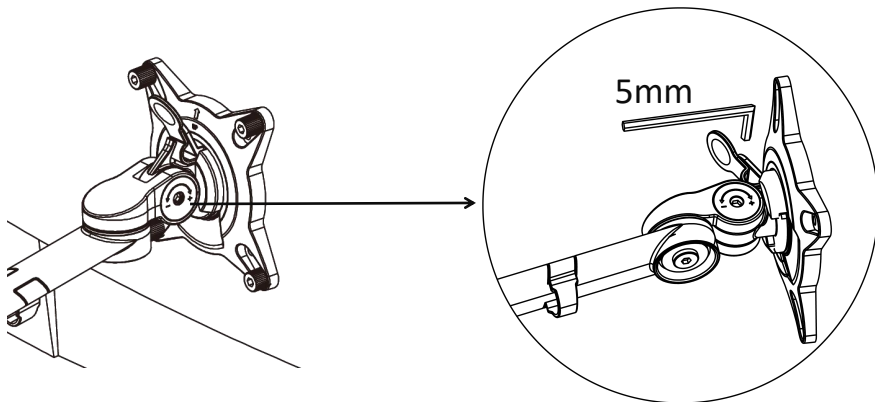

## STEP 5 - Cable Management

### 5-1

Take off the wire clip on the arm.

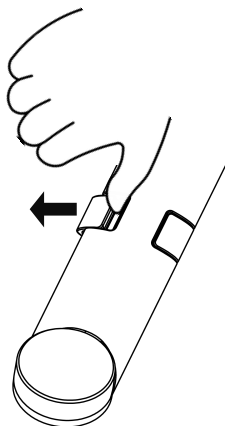

### 5-2

Insert the cable into the wire clip, then put it back to arm.

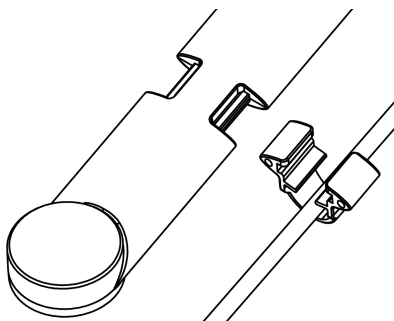

5-3

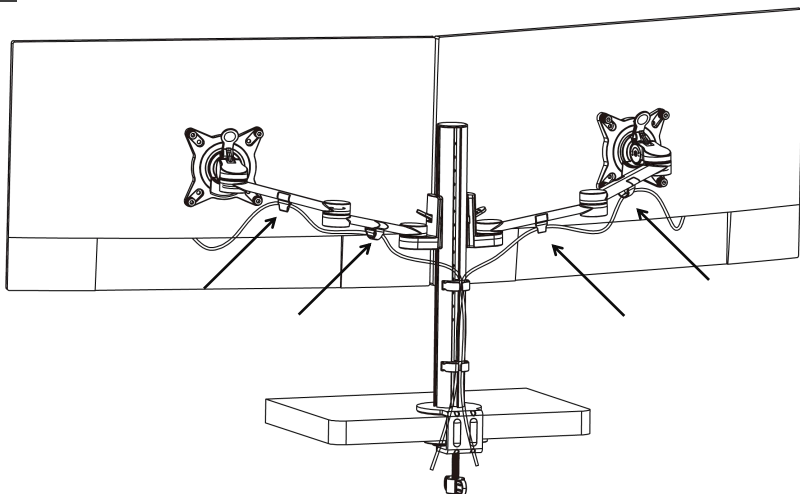

## NOTE

For better adjustment, please hold the monitor during the up/down adjustment process.

