

NL120BT
NL144BT

Assembly Instructions

Thank you for purchasing this product from Global. Before you begin assembly, check that you have all the parts and hardware shown on this page.

If there is any item missing, circle the item, indicating quantity required and return to us by fax or mail:

CANADA
Global Upholstery
560 Supertest Road
Downsview, Ont.
M3J 2M6
TEL. (416)661-3660
FAX. (416)661-4300
Attn.: Customer Service

US
Global Industries Inc.
17 West Stow Road
P.O. 524
Marlton, NJ 08053
TEL. (856)596-3390
FAX. (856)596-5684
Attn.: Customer Service

TOOLS REQUIRED

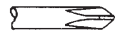

PHILLIPS
Screwdriver size #2

It is advisable to assemble unit on a carpet to avoid scratches.

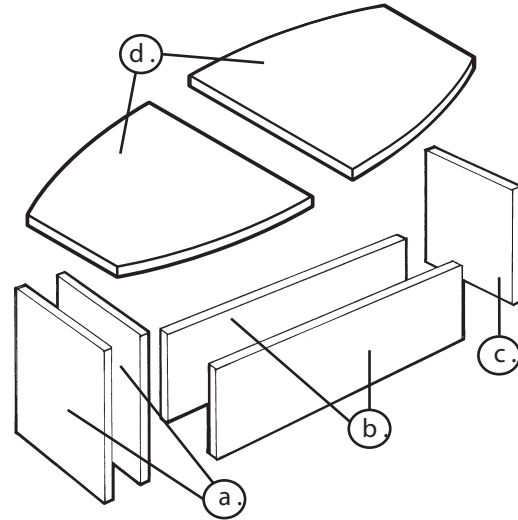

- a. Leg x2
- b. Modesty panel x2
- c. Inside Leg
- d. Top x2

Notice to installers:
Open and assemble only one product at a time to avoid a potential mix up of parts and hardware.

NAIN02 rev: 00 Hardware

GEN222

Leveller 5/16" - 18 x 15/16" Base,
1 1/8" Stem

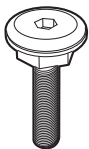

X 6

FST066

Minifix 15 Cam,
Housing, 12.5mm Length

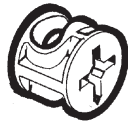

X 28

FST070

Minifix Connecting Bolt



X 28

CST318

Transaction top
Flat Plate

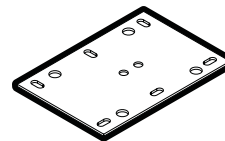

X 2

FST028

#8 x3/4 Pan HD.



X 12

ABAG 37 Rev:02

Step

1

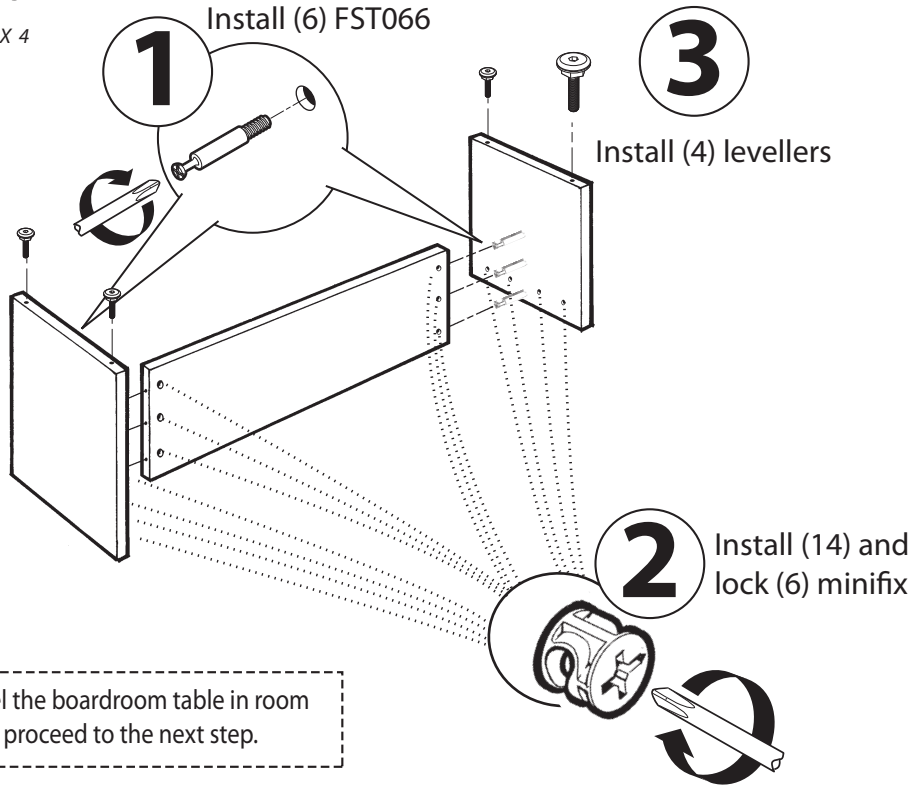
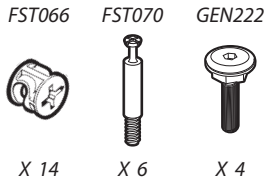

Locate and Level the boardroom table in room before you proceed to the next step.

Step

2

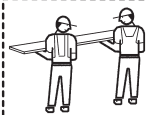
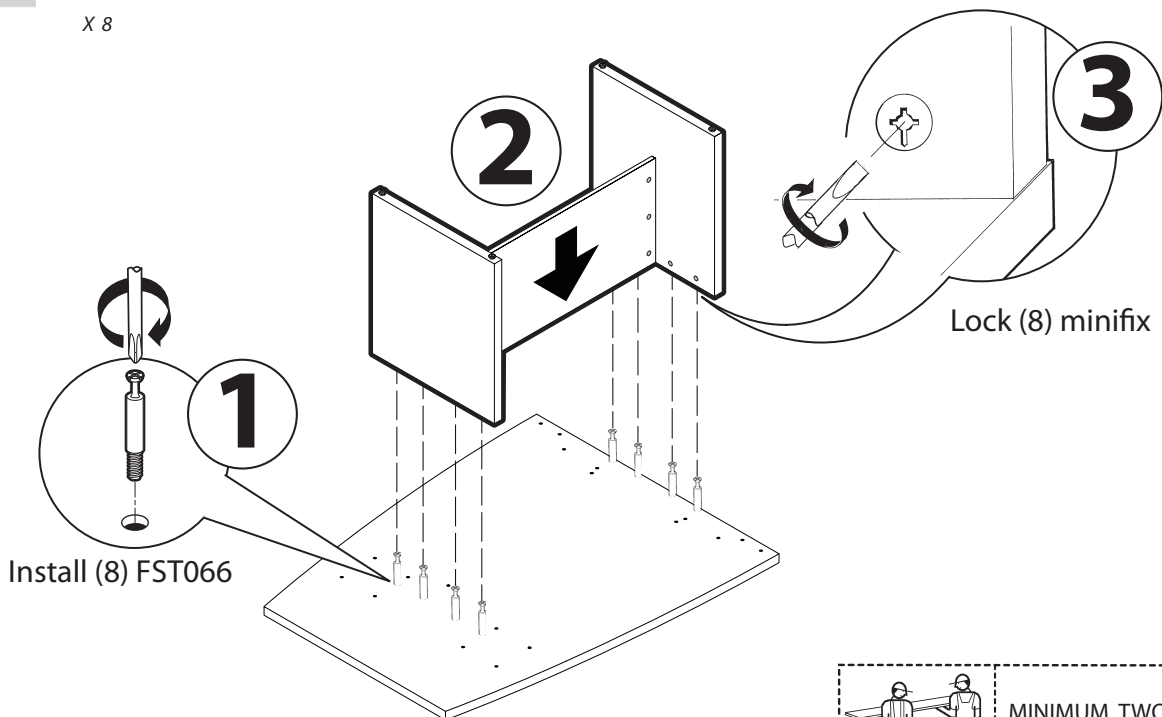
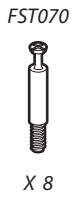

MINIMUM TWO PEOPLE
REQUIRED FOR THIS STEP

Step **3**

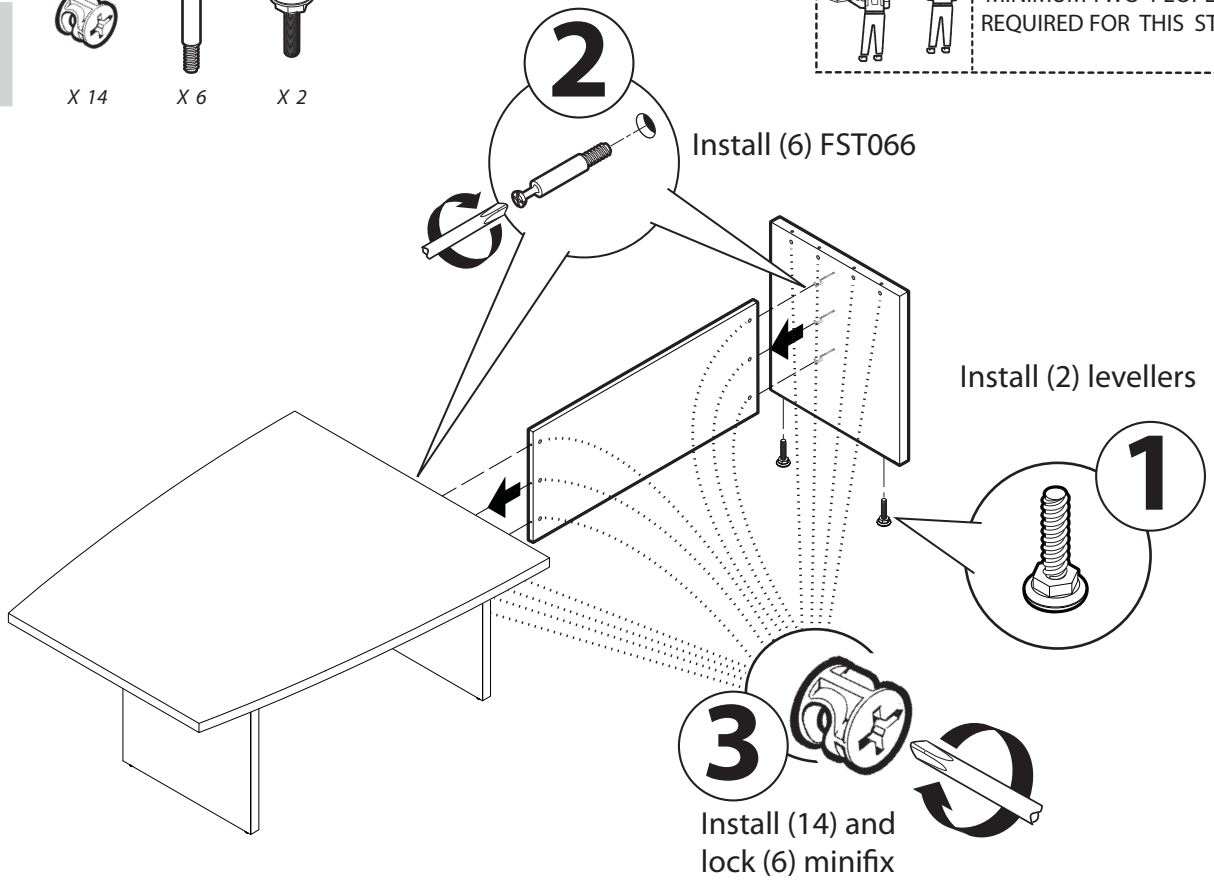

Step **4**

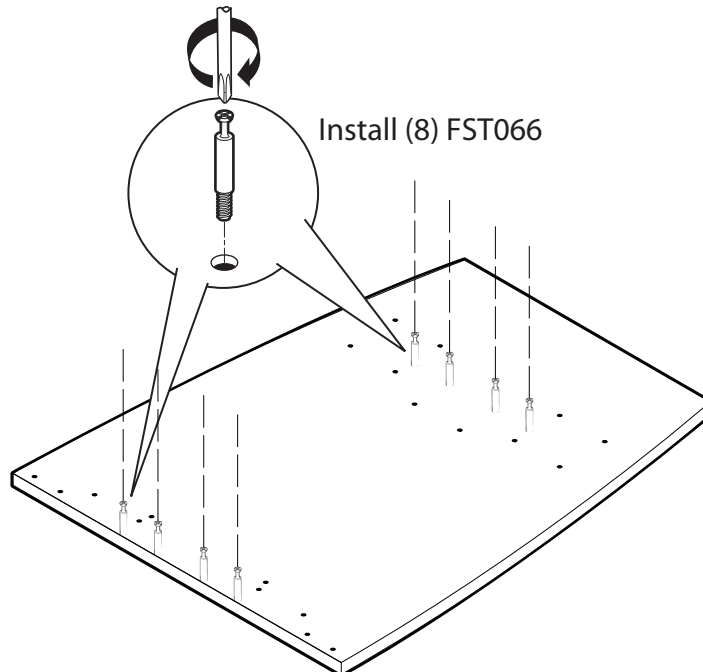
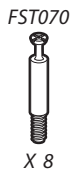

Step 5

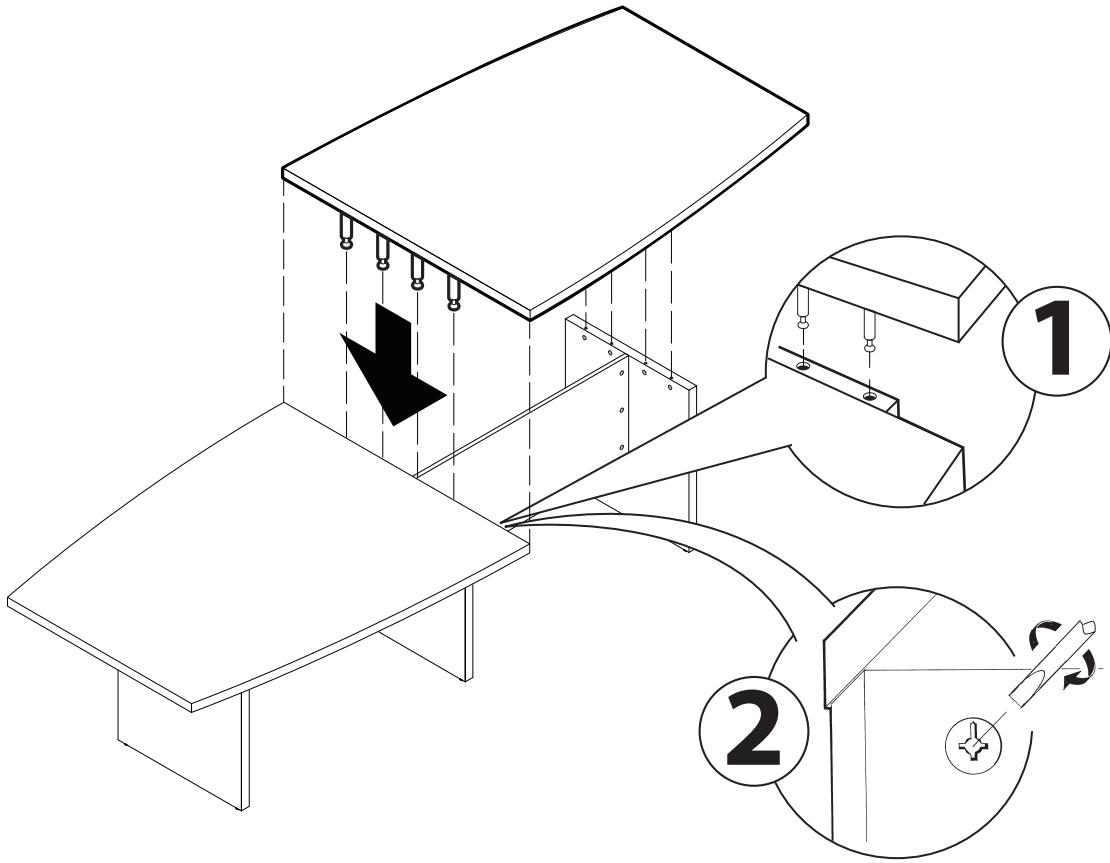

Step 6

- FST028 X 12
- CST318 X 2

