

NL3024R  
NL3624R  
NL4224R  
NL4824R

# Assembly Instructions

Thank you for purchasing this product from Global. Before you begin assembly, check that you have all the parts and hardware shown on this page.

If there is any item missing, circle the item, indicating quantity required and return to us by fax or mail:

## CANADA

Global Upholstery  
560 Supertest Road  
Downsview, Ont.  
M3J 2M6  
TEL. (416)661-3660  
FAX. (416)661-4300  
Attn.: Customer Service

## US

Global Industries Inc.  
17 West Stow ROAD  
P.O. 524  
Marlton, NJ 08053  
TEL. (856)596-3390  
FAX. (856)596-5684  
Attn.: Customer Service

### TOOLS REQUIRED

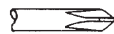

**PHILLIPS**  
Screwdriver size #2

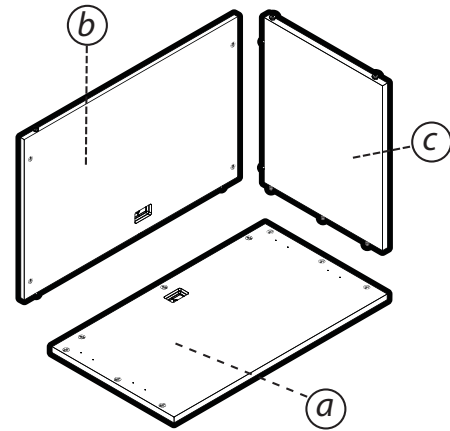

- a. Top
- b. Modesty Panel
- c. Gable

**Notice to installers:**  
Open and assemble only one product at a time to avoid a potential mix up of parts and hardware.

It is advisable to assemble unit on a carpet to avoid scratches.

NAIN 16 rev: 00

**FST030**  
#8 x9/16 Pan HD.



x 2

**FST028**  
#8 x3/4 Pan HD.



x 14

**CST318**  
TRANSACTION TOP  
FLAT PLATE

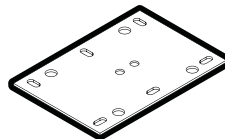

x 2

**CST207**  
"S" TYPE PLATE

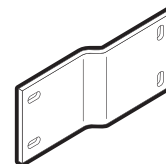

x 1

**GEN 160**  
Rectangular Grommet

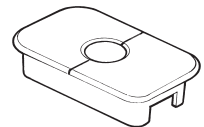

x 2

Step

1

Make sure **ALL** gable's pins are facing inwards

Configuration 1

OR

Configuration 2

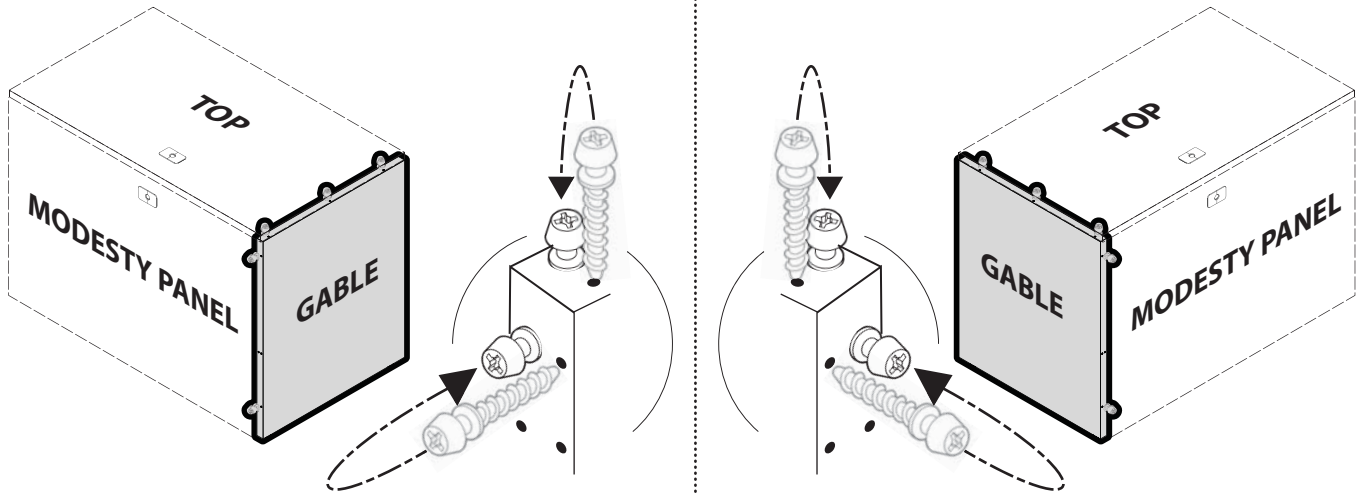
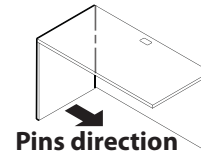
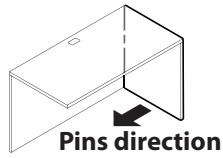

Step

2

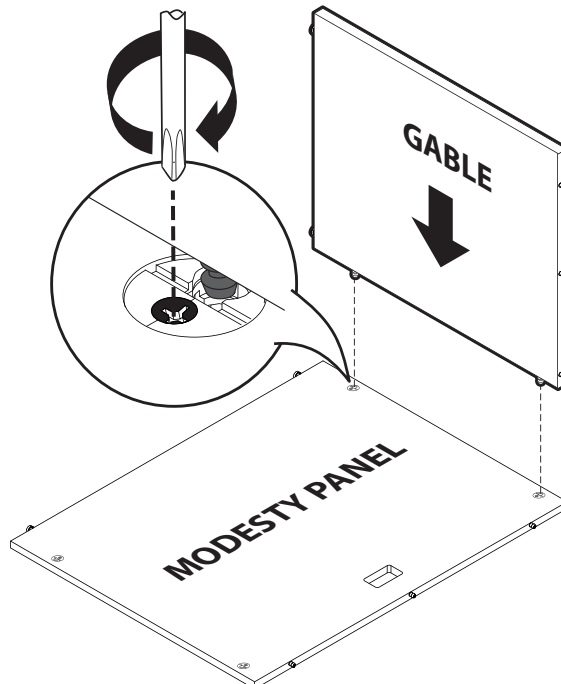

Step **3**

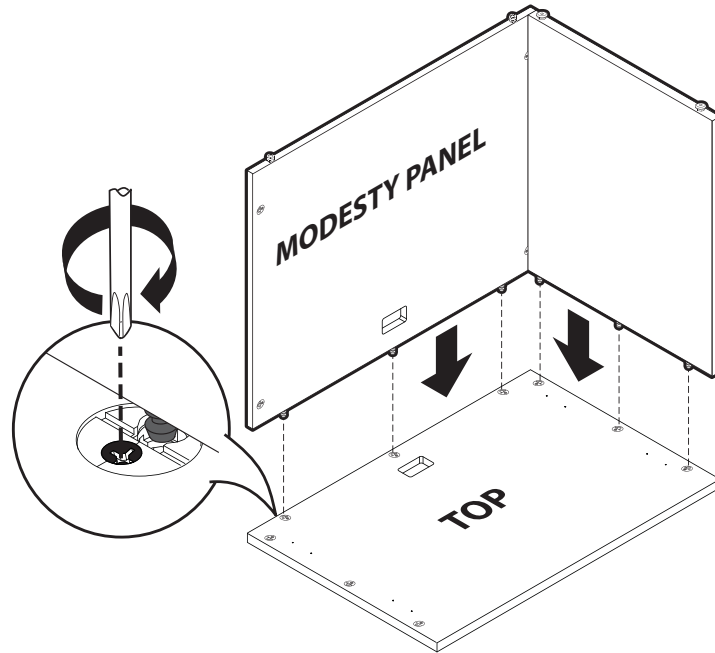

Step **4**

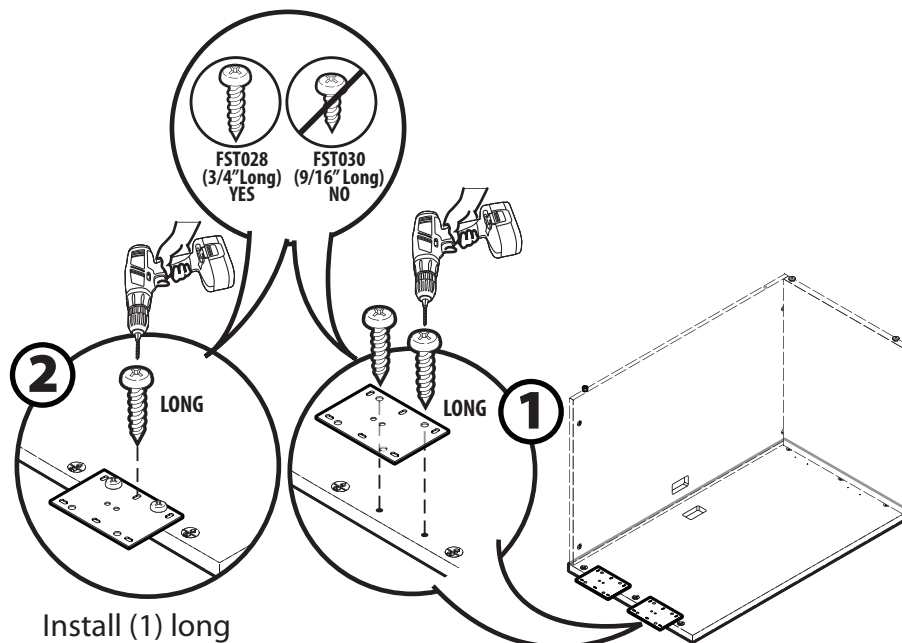
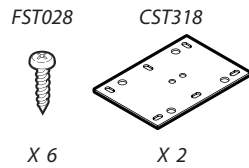

Install (1) long screws for each plate, but **DO NOT** tighten

Install (2) long screws for each plate, but **DO NOT** tighten

Step

5

FST030



X 2

FST028



X 8

CST207

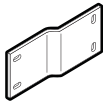

X 1

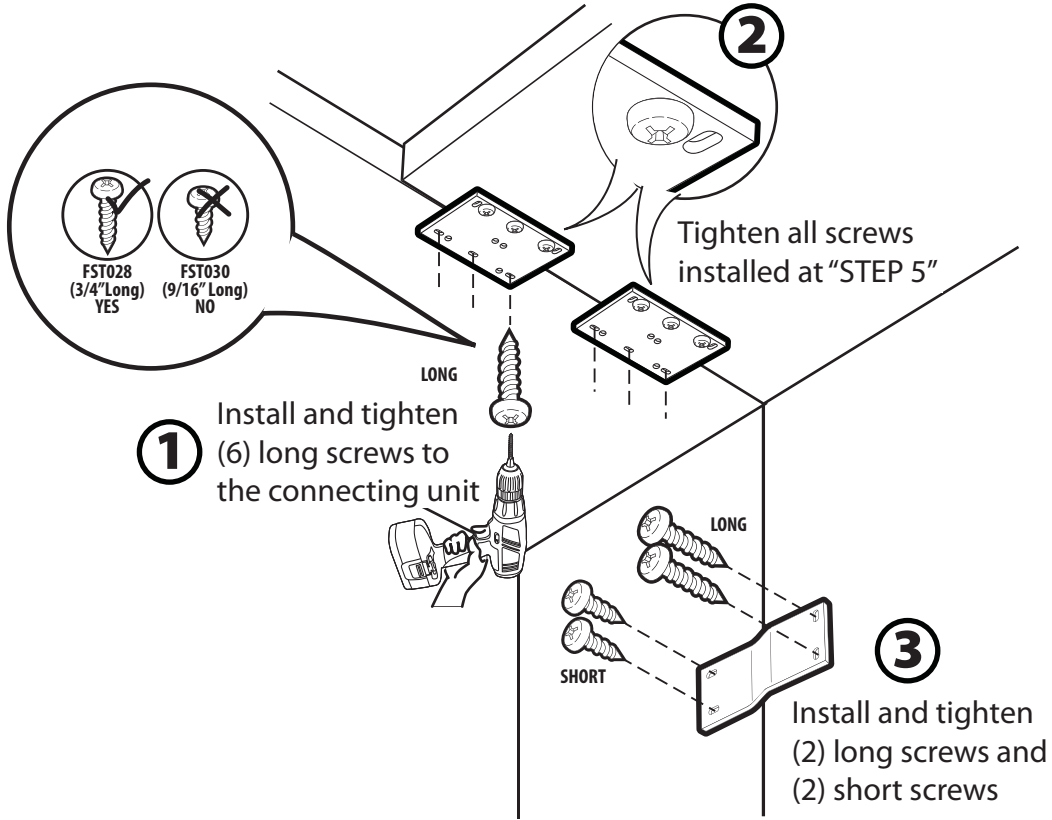

Step

6

GEN160

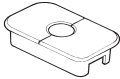

X 2

